

PLAN NO 1964
FOR THE IMPROVEMENT OF
MAYFIELD AVENUE
 BETWEEN
 44TH STREET & 48TH STREET
 IN THE
 CITY OF SAN BERNARDINO
 CALIFORNIA

JUNE 1951 R.D. FORSYTHE
 City Engineer

PLAN ADOPTED - July 2, 1951

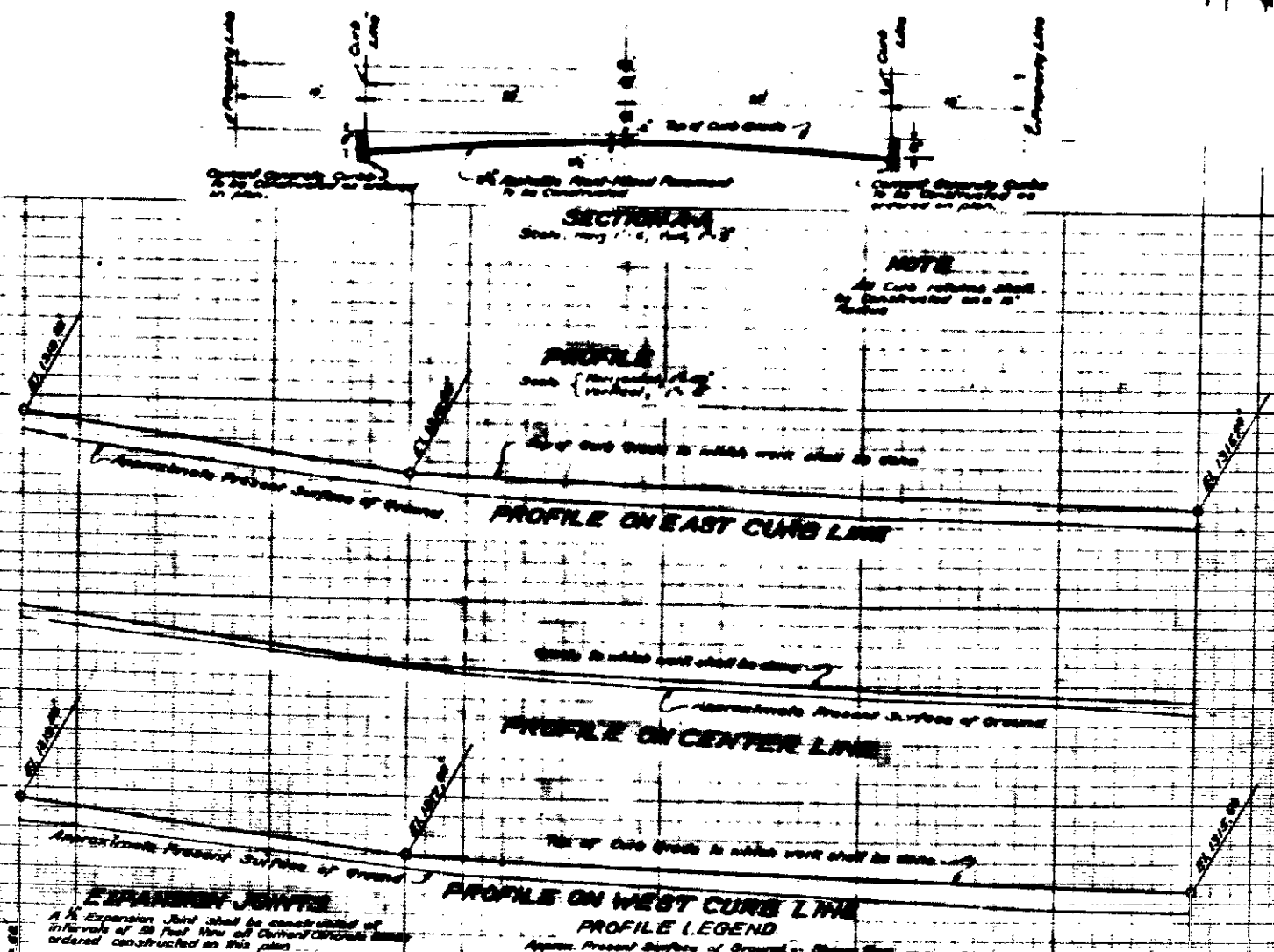
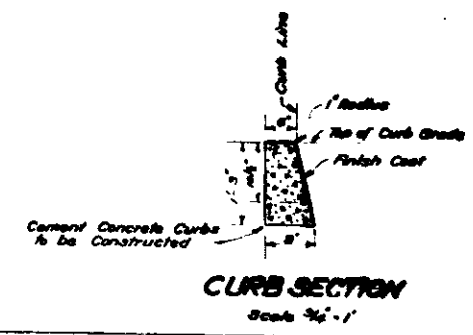
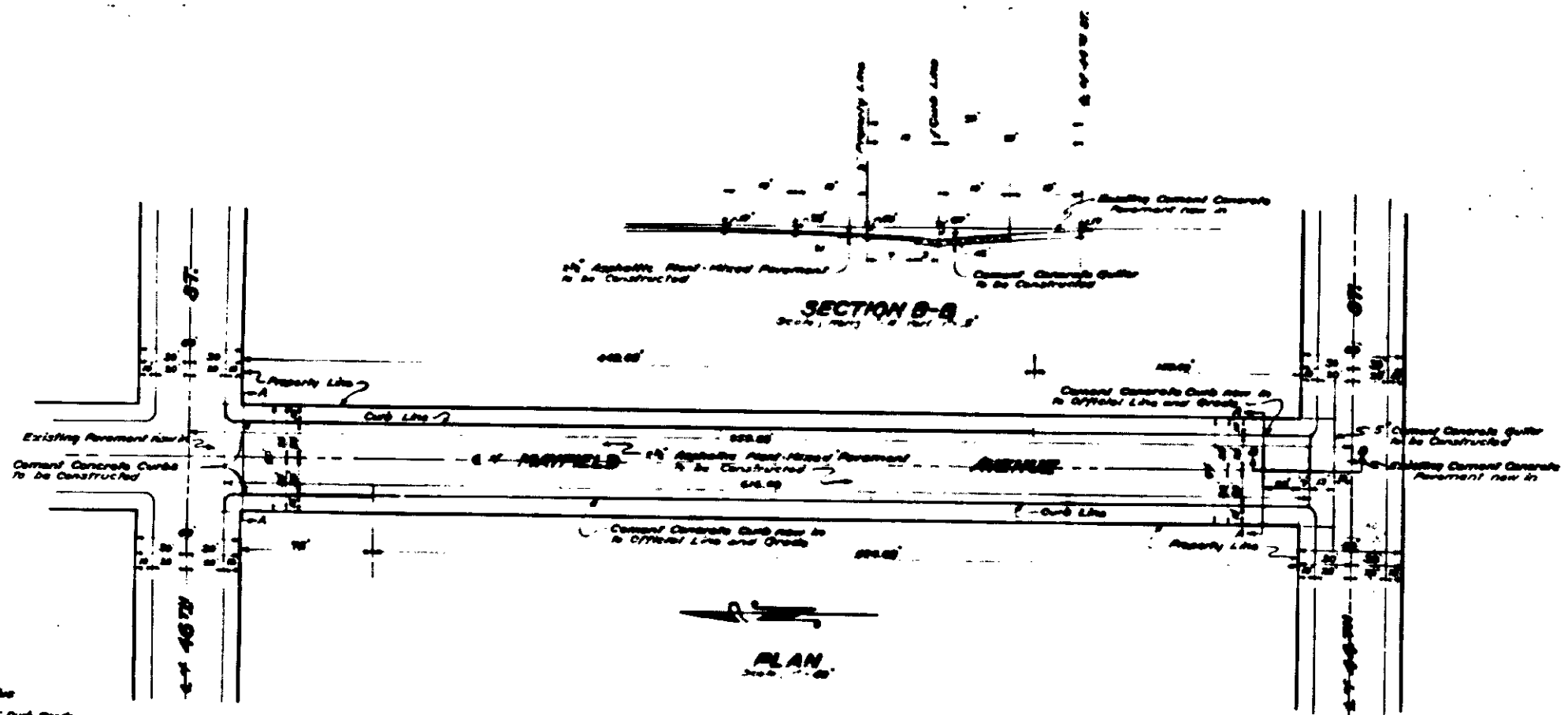

LEGEND

1/4" means inch or 1/4 inch
 10' R. means 10 feet or feet
 NR means number
 C means Center Line
 El. means Elevation
 Cement Concrete Curbs to be Constructed
 Asphaltic Road-Mixed Pavement to be Constructed
 Cement Concrete Curbs to be Constructed
 Shown on plan thus: [Symbol] in Section this, [Symbol] in Section this, [Symbol] in Section this, [Symbol] in Section this.

DATUM

All elevations shown in feet and inches are above a plane which is 1045.00 feet below the 1929 Bench Mark as established by Ordinance 343 of the City of San Bernardino, California.

TITLE TO STREETS

MAYFIELD AVENUE dedicated by SEVERANCE AVENUE by Map of TRUST ESTATE ANNAPOLIS SUBDIVISION SEVERANCE ADDITION 1921 Re-recorded in Book 33 of Maps of Page 53 Official Records of San Bernardino County California. Name changed to MAYFIELD AVENUE by Resolution No. 1088 dated 1-10-43.

GRADE ORDINANCE

Width of MAYFIELD AVENUE was established by Resolution No. 111 of the City of San Bernardino, California.

[Handwritten signature]

PLAN No 1964
FOR THE IMPROVEMENT OF
MAYFIELD AVENUE
 BETWEEN
 44TH STREET & 48TH STREET
 IN THE
 CITY OF SAN BERNARDINO
 CALIFORNIA

JUNE 1951

R.D. FORSYTHE
 City Engineer

PLAN ADOPTED - July 2, 1951

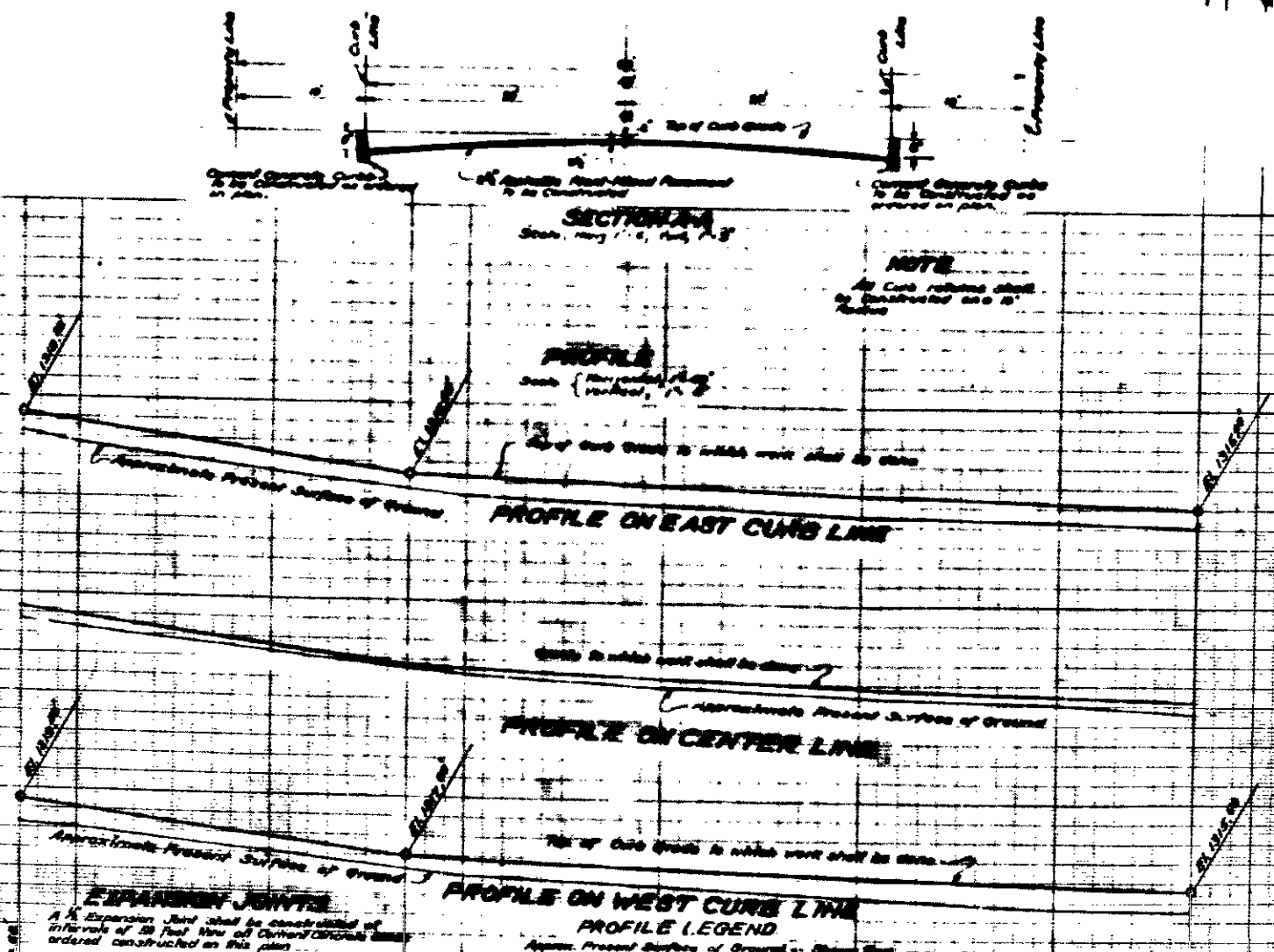
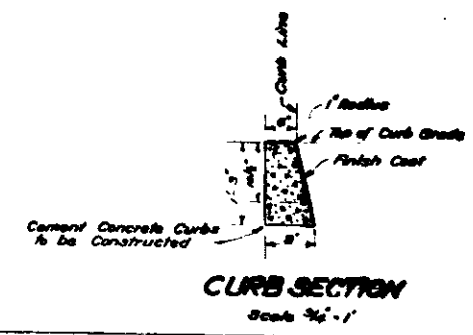
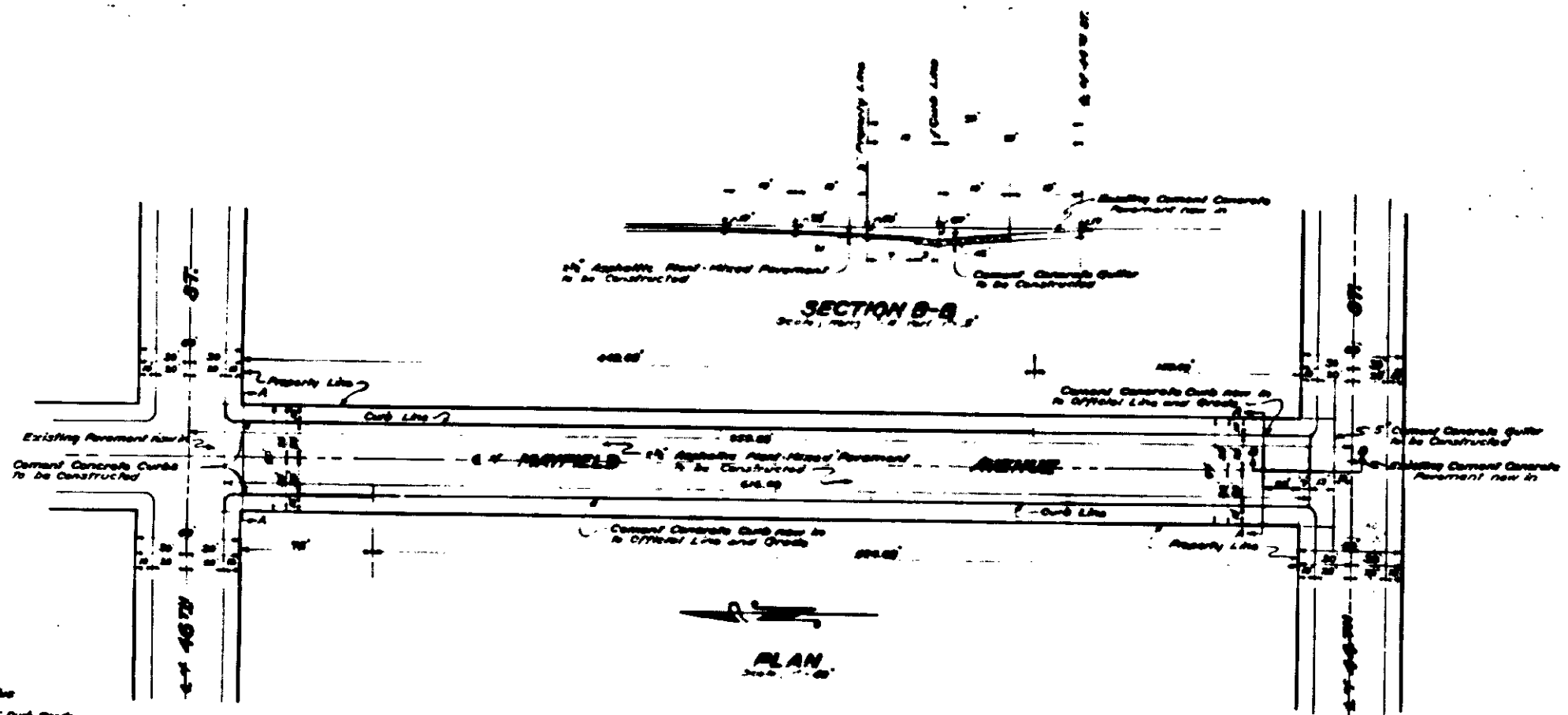

LEGEND

1/4" means inch or 1/4 inch
 1/2" means half or 1/2 inch
 1/8" means eighth or 1/8 inch
 1/16" means sixteenth or 1/16 inch
 1/32" means thirty-second or 1/32 inch
 1/64" means sixty-fourth or 1/64 inch

DATUM

All elevations shown in this plan are in feet and are above a plane which is 1045.00 feet below the 1929 Bench Mark as established by Ordinance 343 of the City of San Bernardino, California.

TYPE OF STREETS

MAYFIELD AVENUE dedicated by SEVERANCE AVENUE by Map of TRUST ESTATE ANNAPOLIS SUBDIVISION SEVERANCE ADDITION 1921 Re-recorded in Book 33 of Maps of Page 53 Official Records of San Bernardino County, California. Name changed to MAYFIELD AVENUE by Resolution No. 1082 dated 1-10-43.

GRADE ORDINANCE

Width of MAYFIELD AVENUE was established by Resolution No. 111 of the City of San Bernardino, California.

[Handwritten signature]